

GENIEMAT[®] FF GENIEBOARD[®]

INSTALLATION GUIDE

MATERIALS

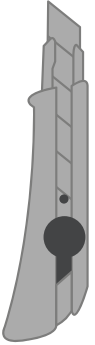

Utility Knife

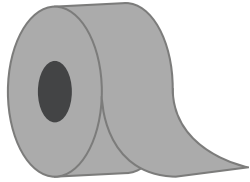

Tape

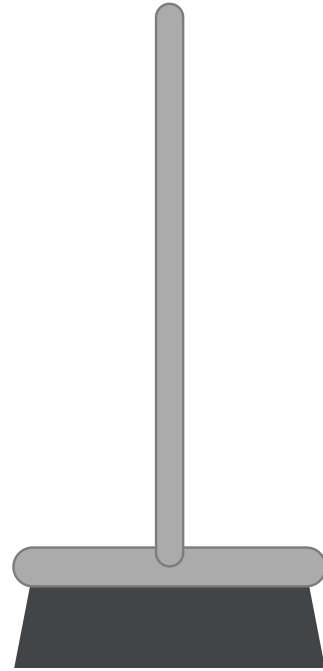

Broomstick

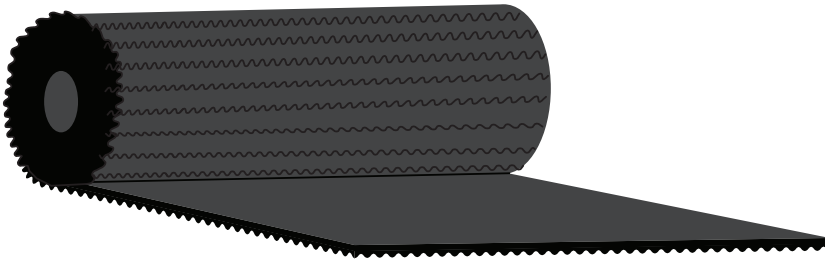

GenieMat FF

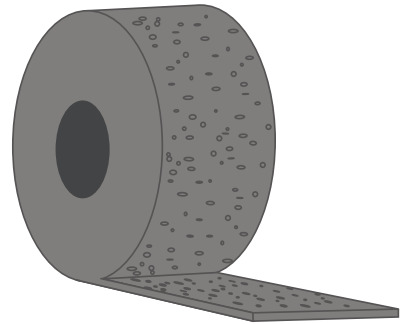

GenieMat PMI

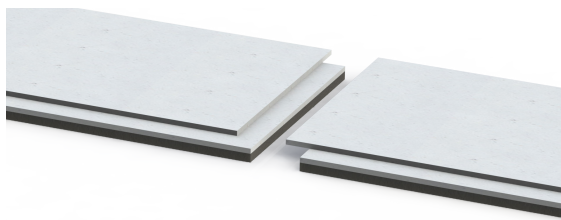

GenieBoard

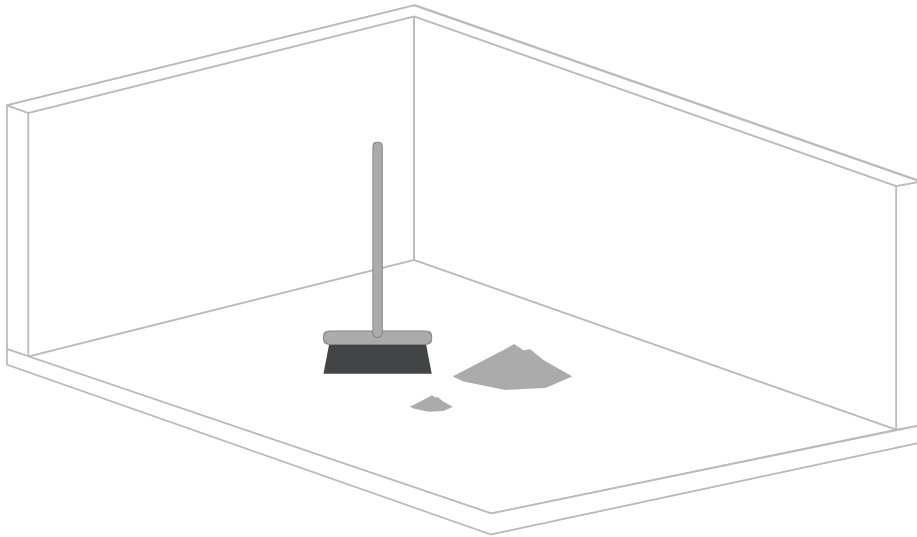
1

Mechanically remove all traces of old adhesives, paint, or other debris by scraping, sanding, or scarifying the substrate. DO NOT use solvents.

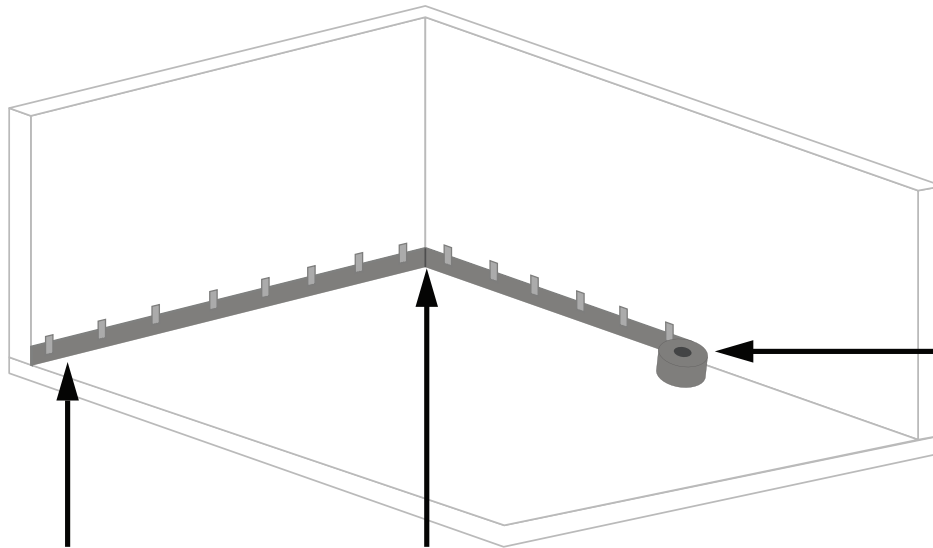
2

Tape GenieMat PMI perimeter isolation strip to the base of the perimeter wall of the entire subfloor, as well as the perimeter of any protrusions.

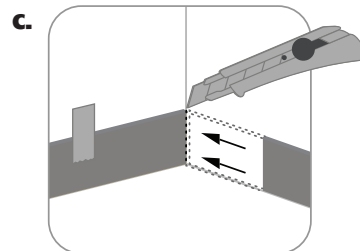
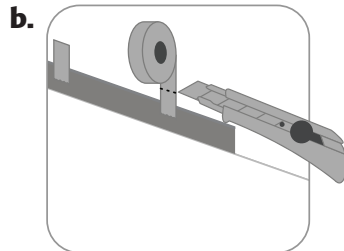
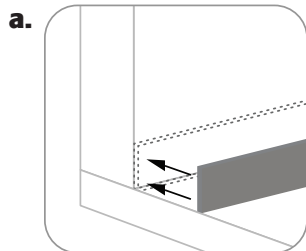

3

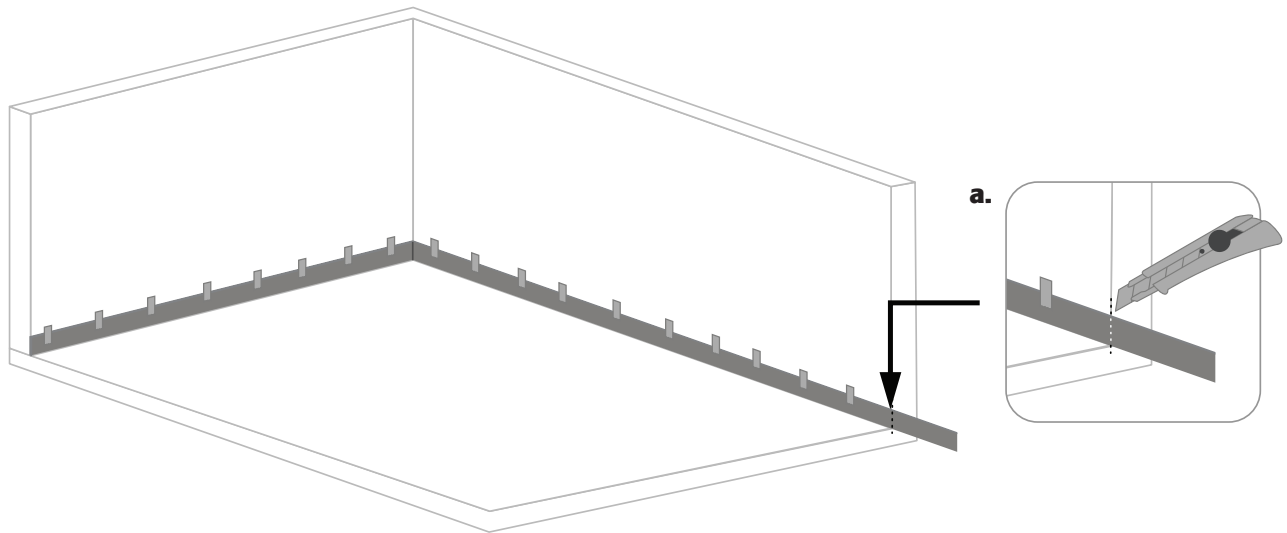

4

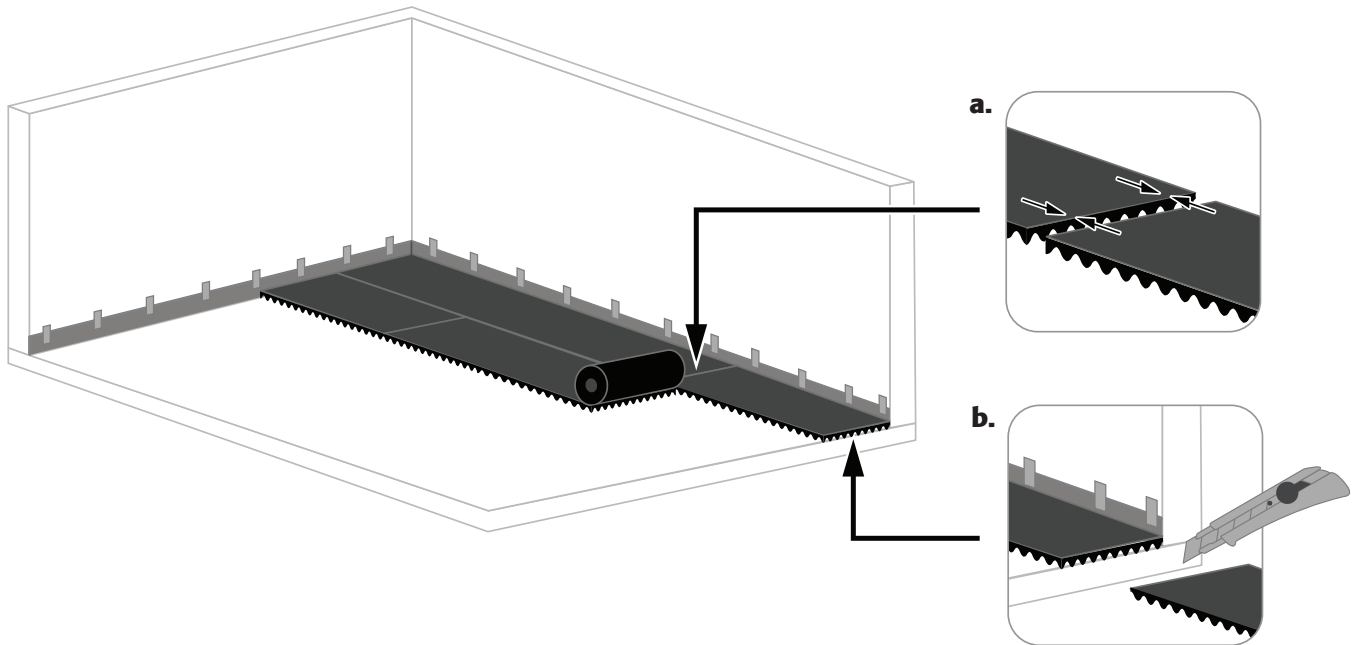

Unroll and place GenieMat FF underlayment dimple-side down and membrane-side up. Align lengthwise edges of underlayment with neighboring sheets by butting them up. Trim ends of each section to fit floor surface area.

5

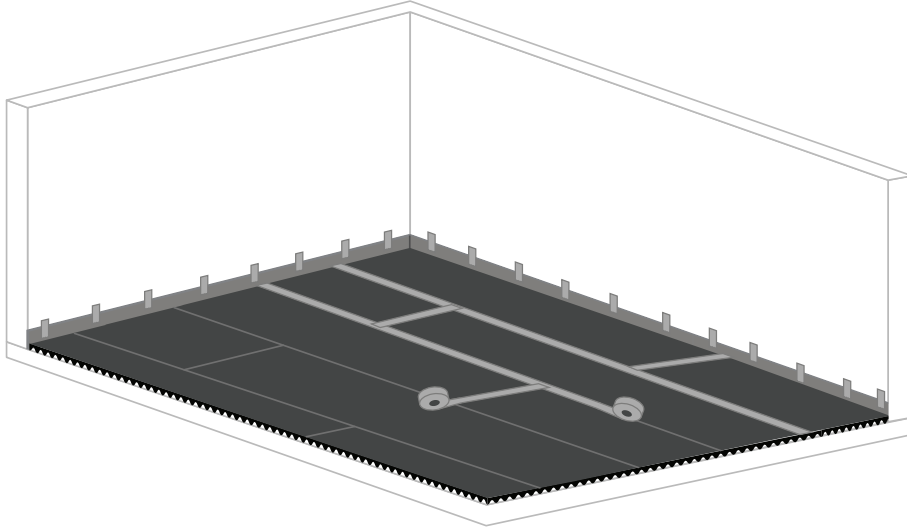

Use duct tape or high-quality carpet tape to secure butt joints and seams, and prevent underlayment from moving.

6

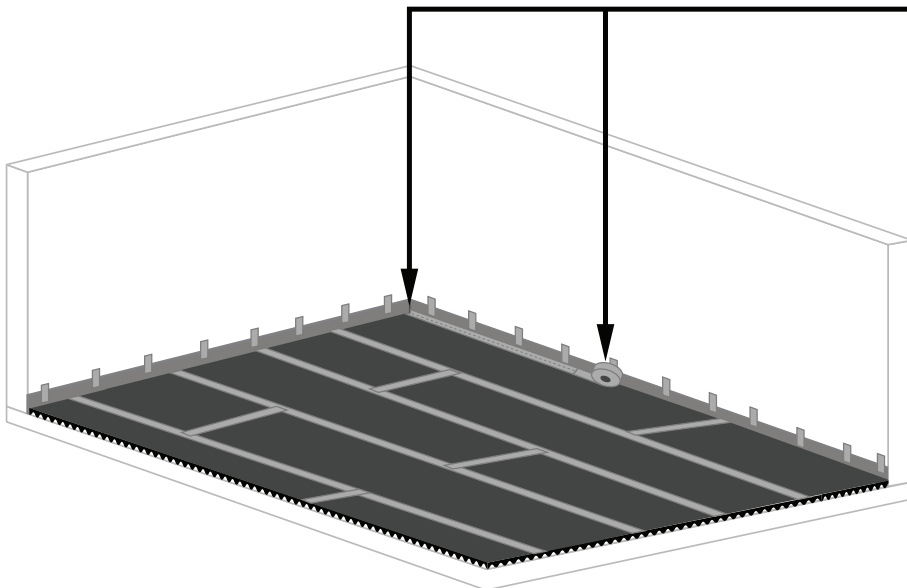

a.

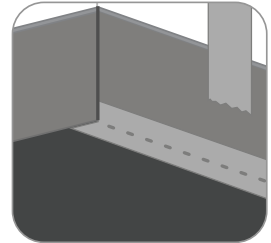

b.

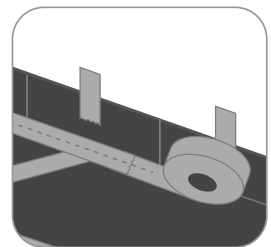

Use **GenieMat® PMI** to wrap all columns, drains, penetrations to ensure there is no hard surface contact with the topping material (GenieBoard)

7

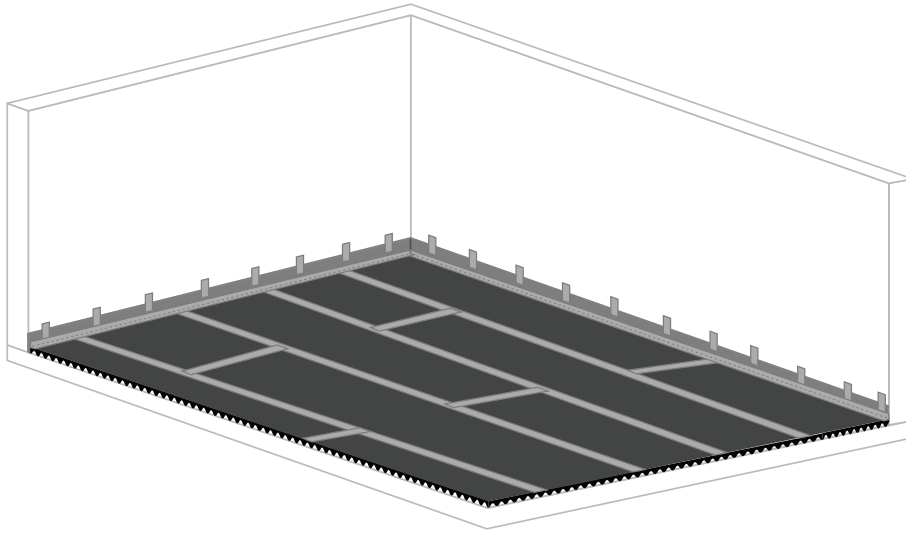

8 GenieBoard Installation

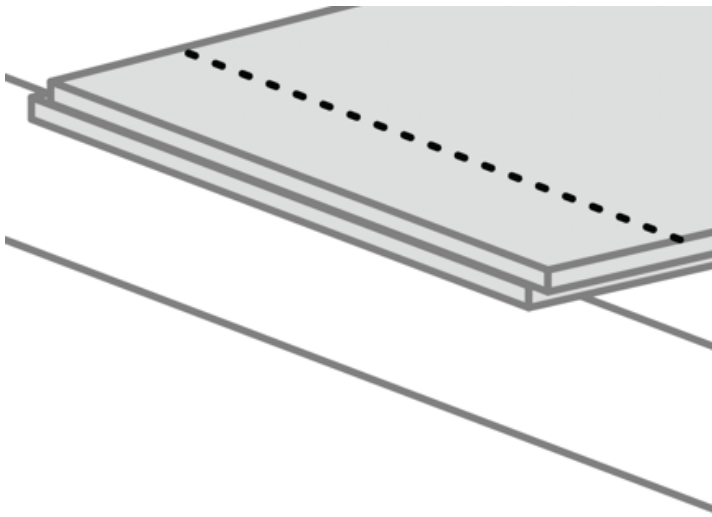

Cut off two sides of the shiplap edge of the first GenieBoard using a handheld circular saw to insure proper fitting against the wall corner. One cut must be along the long side and the other along the short side. It is recommended that the room should be measured (x & y) to understand the most efficient cuts and minimise fillet cuts around the perimeter. The minimum length and width for a board is 250mm.

9



Begin work at one corner of the room and install GenieBoard towards the adjacent corner. Use a handheld circular saw to cut the long edge off boards of the first row. Install them perpendicular to the GenieMat FF installed.

10

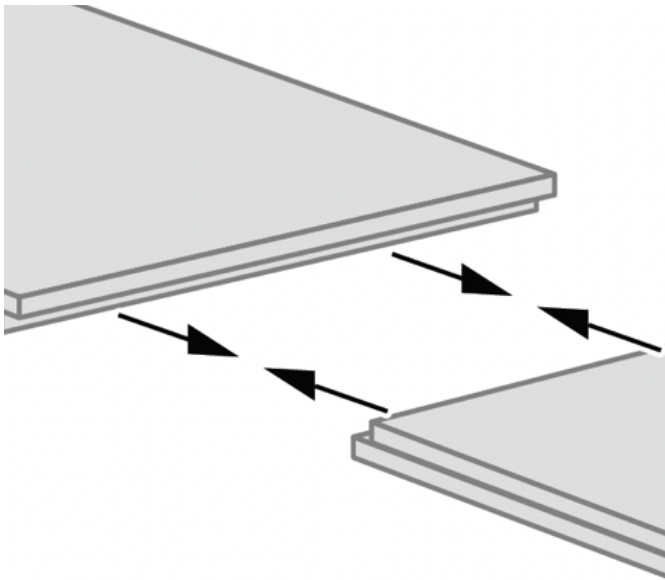

Apply Pliteq approved adhesive to the shiplap element of the GenieBoard then install by connecting the shiplap joints together

11

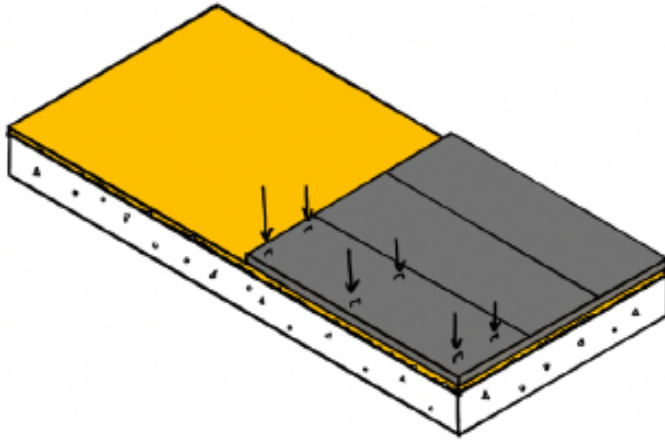

Staple or screw GenieBoard joints at 200mm centres within 10 minutes of fitting the boards together to prevent lipping

12



When you get to the end of an installed row, use a handheld circular saw and trace cut the excess board part. The cut off piece can be used to start the next row. All rows should be offset/staggered from the previous row

13

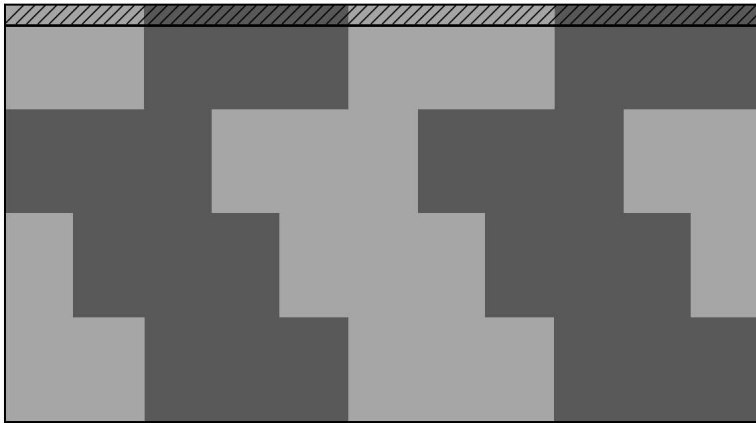

It is recommended to divide any cuts symmetrical at the perimeter of the room. The minimum cut length and width for a board is 250mm. Note, if the cut is under 250mm do not adopt the symmetrical approach.



11.23

© Pliteq. 2023.

®™ Trademarks of Pliteq Inc. The information provided is accurate to the best of our knowledge at the time of issue. However, we reserve the right to make changes when necessary without further notification. Suggested application may need to be modified to conform with local building codes and conditions. We cannot accept responsibility for products that are not used, or installed, to our specifications. All listed dimensions are nominal.

www.pliteq.co.uk